



Moore House, 2 Gatliff Road
London SW1W

GARTON JONES.COM



Moore House, 2 Gatliff Road London, SW1W

£425 Per Week

GARTON JONES.COM

8 Gatliff Road
Grosvenor
Waterside
Chelsea
London
SW1W 8DP

Sales +44 (0) 20 7730 5007
gws@gartonjones.com
www.gartonjones.com

A STUDIO apartment of to RENT of approx. 279 sq.ft (25.9 sq.m) in Moore House, part of the popular Grosvenor Waterside development in Chelsea. This STUDIO apartment is furnished and offers an open plan studio/reception room, a fitted kitchen, a luxury bathroom and wood flooring with UNDERFLOOR HEATING.

There is a 24 HOUR CONCIERGE, GYM and SPA. On-site Sainsbury's Local, coffee shop and private kids club. The additional amenities including shops, restaurants and the excellent transport links of both Sloane Square and Victoria are within walking distance. Battersea Park is also a short stroll away via Chelsea Bridge.

*Please note furniture and layout may differ to that shown in the current photos.

Available via Garton Jones' on-site office at Grosvenor Waterside (underneath Bramah House).

Council Tax: Westminster City Council (band D).

12 month minimum term. 5 week deposit required.

EPC certificate available on request.

- 279 Sq.ft (25.9 Sq.m)
- Studio Apartment
- Fitted Kitchen
- Open Plan Living
- Luxury Bathroom
- 24 Hour Concierge
- Underfloor Heating
- On-Site Residents' Gym & Spa Facilities, Crèche, Coffee Shop, Sainsbury's Local & Coffee Shop
- Close To Victoria Station & Sloane Square
- Available Via Garton Jones Chelsea & Belgravia (On-Site Underneath Bramah House)



Approximate Gross Internal Area
271 sq ft / 25.22 sq m
Type: 30.1

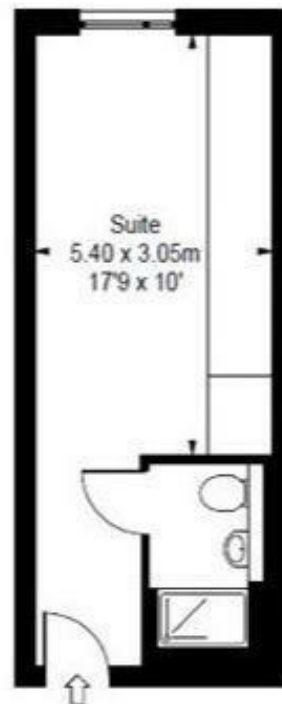

ILLUSTRATION FOR IDENTIFICATION PURPOSES ONLY

ALL MEASUREMENTS ARE MAXIMUM, AND INCLUDE WINDOW BAYS AND WARDROBES WHERE APPLICABLE
THIS PLAN MUST NOT BE REPRODUCED BY ANY OTHER PERSON WITHOUT PERMISSION

